

Appendix 4

GRAVITY & SURVEY REFERENCE STATION RECOVERY SKETCHES

Station Name			Station Location			Station Number
RAINBOW HILL			26611 Bass Hwy, Rainbow Hill			8100
STATION INFORMATION						MARK DETAIL
Coordinate	327,825.65	5,464,508.06	m	Datum	AMG Z55-AGD66	
Elevation		89.590	m	Datum	AHD83 (Tas)	
Gravity			mGals	Datum		
Station Type	GPS Reference Station					
Estab. By	AUSPOS for Position					
Placed By	Integrated Mapping Technologies P/L		Date	20/02/2008		
Mark Desc'n	60cm SIP deep driven to ground level with 1.5m SIP witness post					

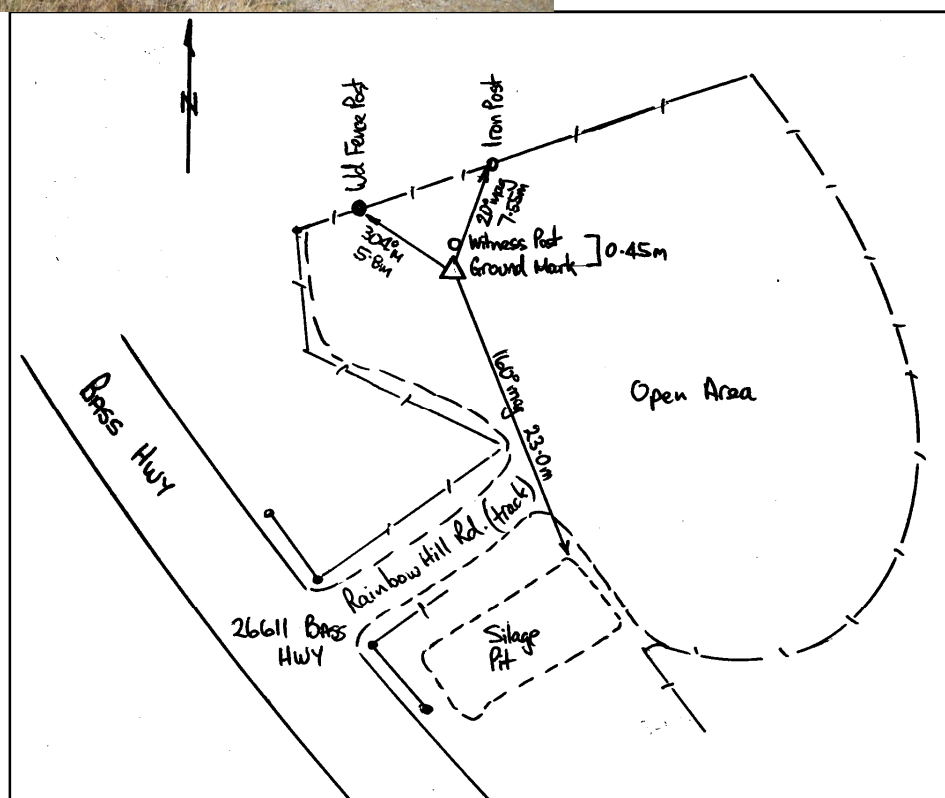
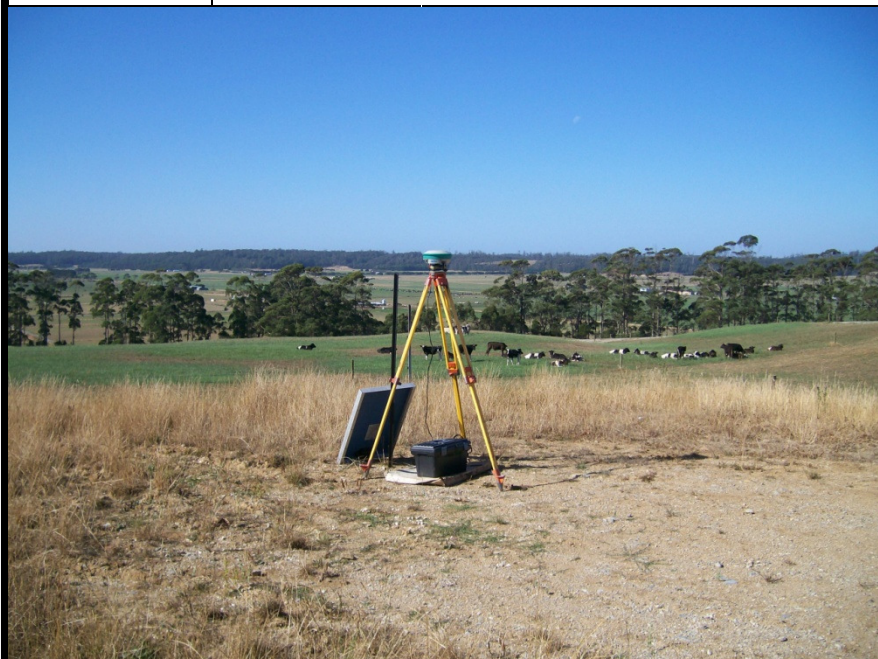

Station Name			Station Location			Station Number
POKES HILL TRIG			Watery Plains Rd, Blessington, Tasmania			1083
STATION INFORMATION						MARK DETAIL
Coordinate	341965.57	5472853.98	m	Datum	AMG Z55-AGD66	
Elevation		80.435	m	Datum	AHD83 (Tas)	
Gravity			mGals	Datum		
Station Type	GPS Reference Station					
Estab. By	AUSPOS for Position					
Placed By	Integrated Mapping Technologies P/L	Date	23/02/2008			
Mark Desc'n	Existing eccentric mark RM2 O/L to ST 127. 2m steel star picket at ground level in concrete.					

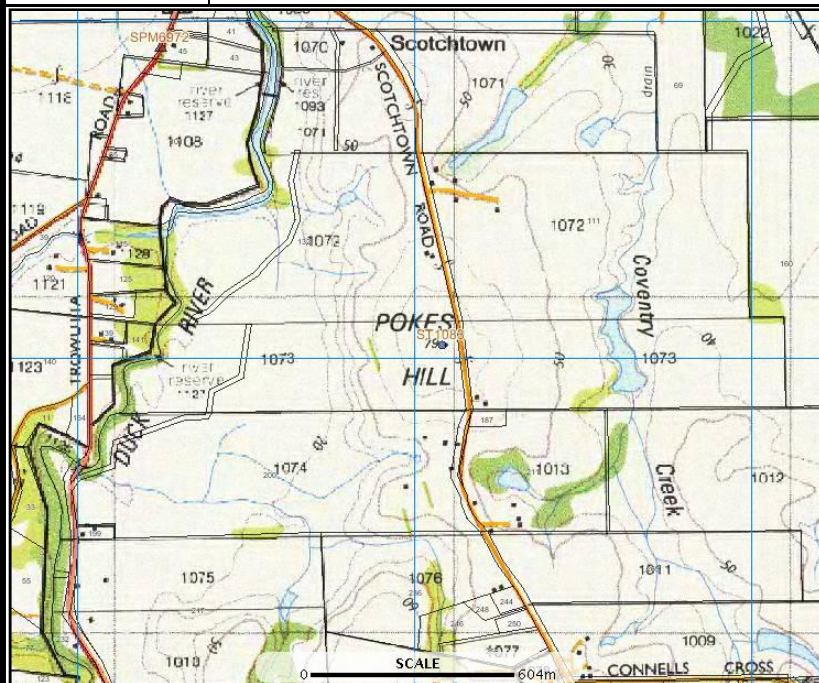

NOTE:-

The position of this mark has been re-determined using AUSPOS Space geodesy based on 5 days GPS GLONASS data submitted as 5 separate files with results being averaged.



[illegible]